

# Magnet drive gear pump-motor units

## DGM09 series

The DGM09 series magnet drive gear pumps derive from the well established mag drive MG200 series.

Built to handle clean water and relatively viscous fluids at low pressure, the DGM09 series pump-motor unit has low pulsation and is capable of handling fluids at a maximum temperature of 95 °C (203 F). The pump housing and the gears are made of Vectra. Seals are available in NBR, EPDM or VITON®.

The seal less design is guarantee of reliability. Suction/discharge ports are 8 mm barbed end.

- Motor: 12-24 V DC, 3000 rpm, brush type



### MAIN APPLICATIONS

- Water purification
- Laser cooling
- Spraying
- Water recirculation
- Condensation removal
- Low pressure carbonation
- Sanitization



### MODEL NUMBER MATRIX

Position	1	2	3	4	Customiz.	POS	DESCRIPTION	CODE
Code	DGM	09	E	M01	0000	1	Pump series	<b>DGM</b> = magnet drive
						2	Gears width thickness	<b>09</b> = 9 mm
						3	Elastic material	<b>E</b> = EPDM <b>N</b> = NBR <b>V</b> = VITON®
						4	Motor	<b>000</b> = none <b>M01</b> = 3000 rpm/24V <b>M03</b> = 3000 rpm/12V

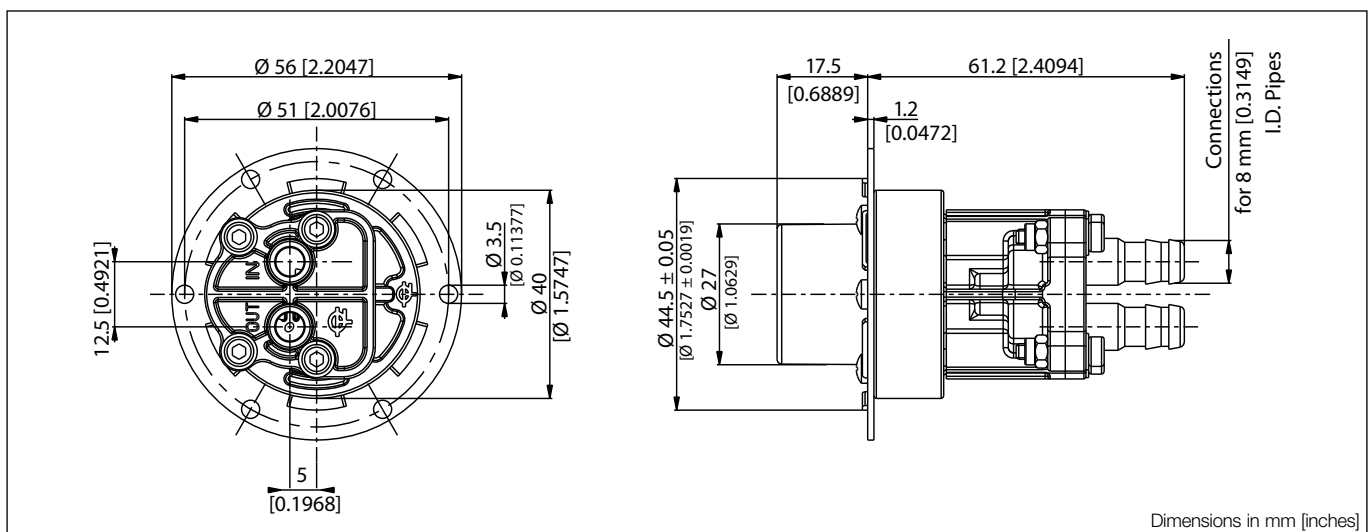

\* Dimensions without motor and adapter

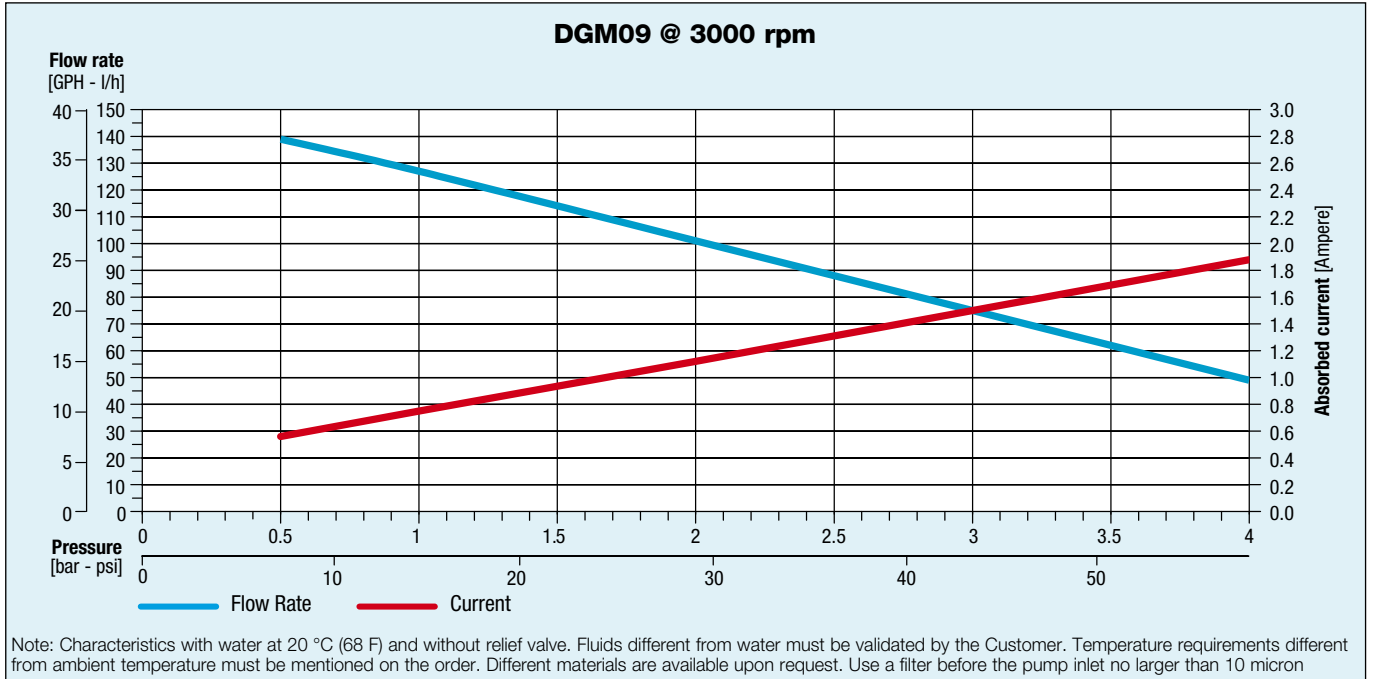

Fluid-o-Tech reserves the right to alter the specifications indicated in this catalogue at any time and without prior notice.

**Fluid-o-Tech srl**  
 Via Leonardo da Vinci, 40  
 20094 Corsico, Milano, Italy  
 Tel. +39 02 9995 01  
 Fax +39 02 9995 0999  
 info@fluidotech.it

**Fluid-o-Tech Int'l Inc.**  
 161 Atwater St.,  
 06479 Plantsville CT (USA)  
 Tel. +1 (860) 276 9270  
 Fax +1 (860) 620 0193  
 info@fluid-o-tech.com

**Fluid-o-Tech Int'l Inc. Japan**  
 2nd Floor, 4-3-8, Espoir Todoroki,  
 Todoroki, Setagaya, Tokyo 158-0082  
 Tel. +81 (0) (3) 6432 1812  
 Fax +81 (0) (3) 6432 1813  
 erkkato@fluidotech.jp

**Fluid-o-Tech Asia (Shanghai) Co., Ltd.**  
 2/F, Factory building 6 (1), No. 258, Zhijiang Road,  
 Fengxian District, Shanghai City, Z.P.: 201499 China  
 Tel. +86 (021) 67100 838  
 Fax +86 (021) 67100 605  
 info@fluidotech-asia.com